

THOMAS YANG STUDIO

Cabinet of Memories

Built from the nostalgia for intersecting cultures, the Cabinet of Memories is based on the proportions of a traditional East-Asian cabinet. The cabinet's devotion to daily objects is found in its reinterpreted design; book splines celebrate the craft of a publication's spine while varying sizes of drawers and doors wrap the cabinet. Intended to hold space for long-term care of objects, the Cabinet of Memories is derived from recollections of Yang's own family heirlooms.

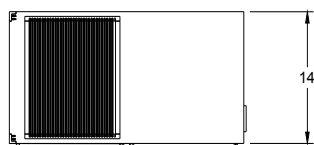
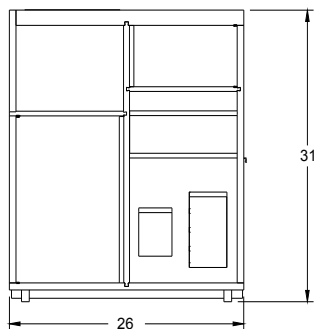

Shown As:
Cherry

Standard Materials:
Wood, Stainless Steel
Hinges, Sterling Silver Fish
Knob

Standard Finishes:
Cherry, Maple, Cedar

Standard Dimensions:
26" L x 14" W x 31" H

Lead Time:
16-18 weeks

Thomas Yang Studio
Materials and Finishes

STANDARD WOOD MATERIAL FINISHES
Custom materials & finish matching available.



Cherry



Maple